

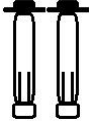





# Instruction

Accessories list				
Desiccant 1PC	Bolts 2PC	Batteries 4PC	Carpet 1PC	Emergency key 2PC
				

## ● HOW TO OPEN THE SAFE

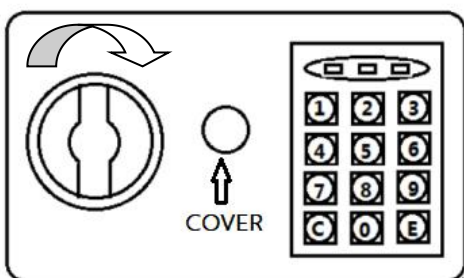

**Step1:** Take off the cover, then insert the emergency key and turn to the left. 

**Step2:** Turn the knob to the right, then open the door.

## ● HOW TO SET USER CODE

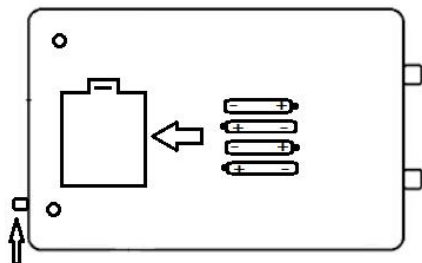

Set Button

**Step1:** When door is open, open the battery compartment, and insert batteries.

**Step2:** When the door is open, push the set button. You can input user code (from 3-8 digits) within 30 seconds. Then press “E” to confirm it.

## ● INSTALLING THE SAFE

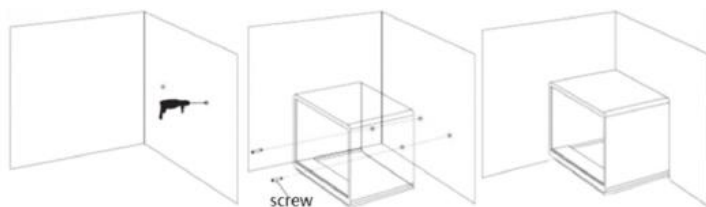

Step1: Place safe against wall

Step2: Mark where holes need to be drilled

Step3: Drill Holes

Step4: Place expansion bolts in holes.

Step5: Align holes in safe with expansion bolts on the wall. Place screws and tighten.

## ● NOTE

**PLEASE DO NOT LEAVE YOUR EMERGENCY KEY IN YOUR SAFE**