

# MANUAL SWEEPER GUIDE

Model 920F







Please make sure you read the instruction manual below and clear the operation before you use this sweeper.

SEVEN

## SPECIFICATION

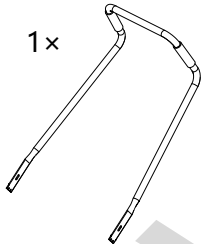
Working width with two side brushes	920 mm
Container Capacity	40L
Maximum Theoretical Area Performance	3680m <sup>2</sup> /h
Net weight	23.8 kg
Dimension (folded)	890x790x385 mm

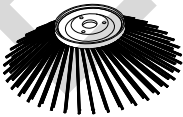
## SPARE PARTS IN THE BOX

1x 	2x 	2x 	6x 
	2x 		

Handle and bolts

Side brush and screws

# HOW TO USE

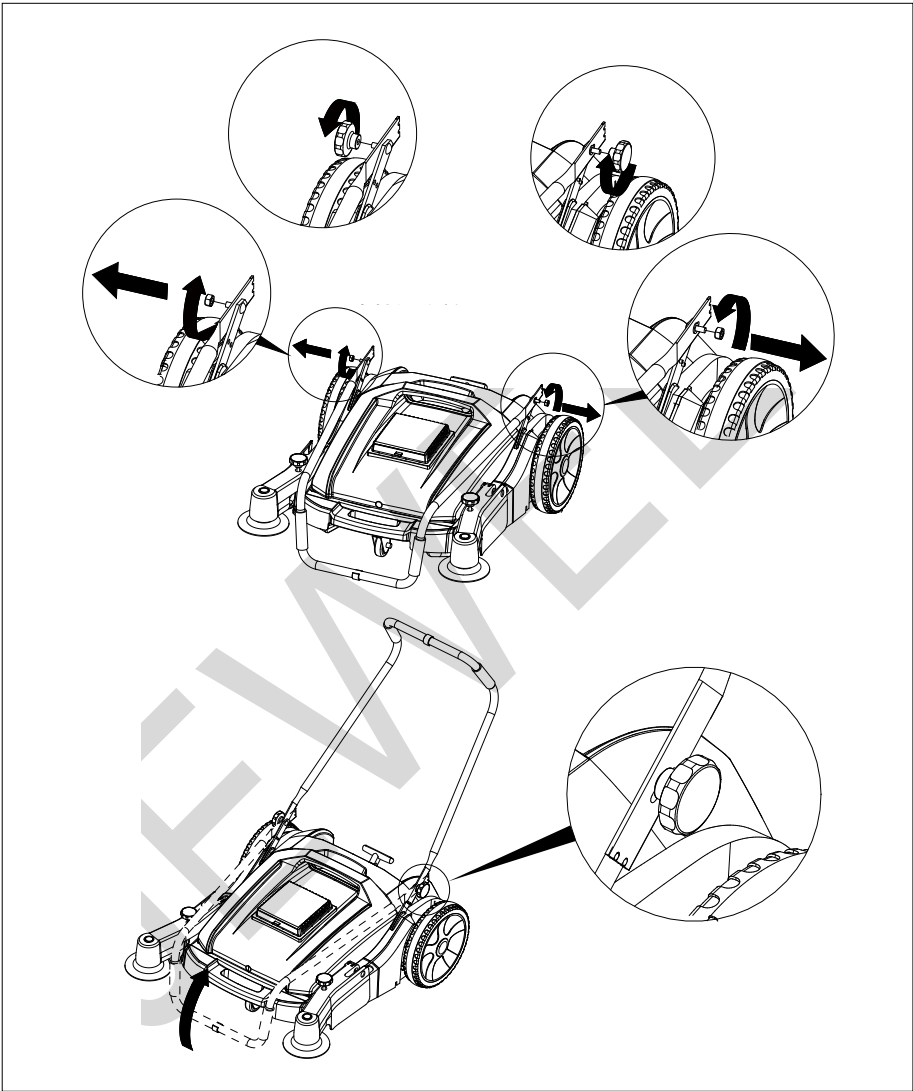

Retaining screw for push handle adjusting. Remove the screws on both sides of handle, and install the turning knob.

## HOW TO USE

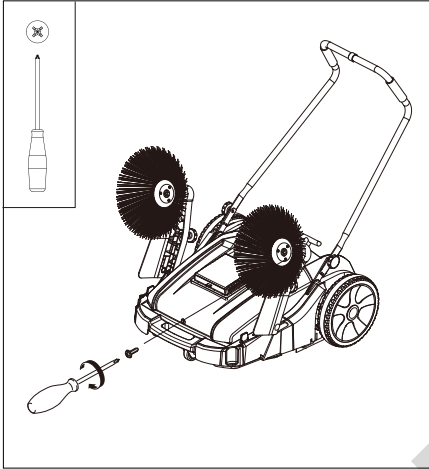

Take out the brushes from the debris container and screw the brushes.

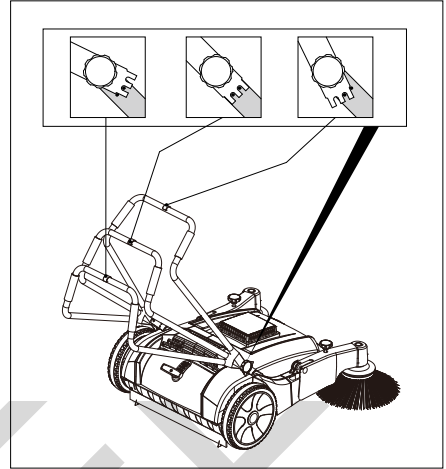

Three-position adjustable handle for operator comfort and convenience.

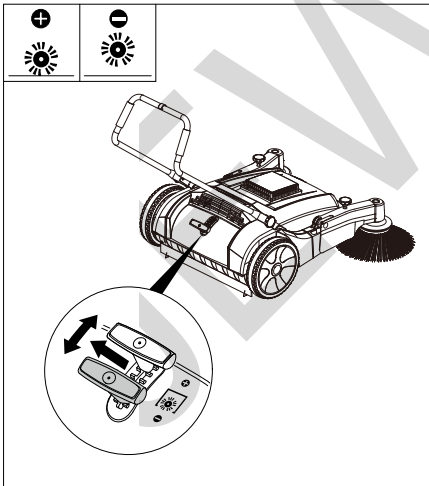

Adjustable roller broom height with 6 different positions.  
Pull out the adjusting lever to the required position.



Easy to adjust front brush pressure for outstanding sweeping performance.  
Turn right to lower brush; turn left to lift brush.

# HOW TO USE

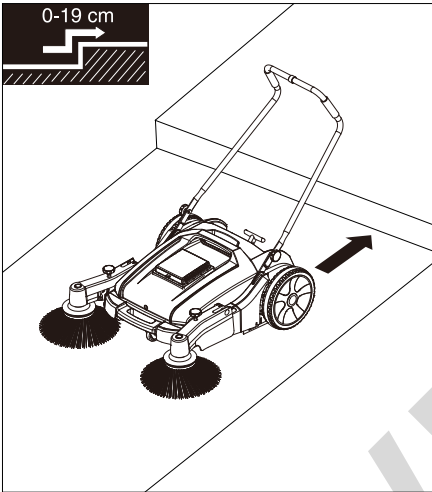

Walking the step in the opposite direction  $\leq 19$ cm.

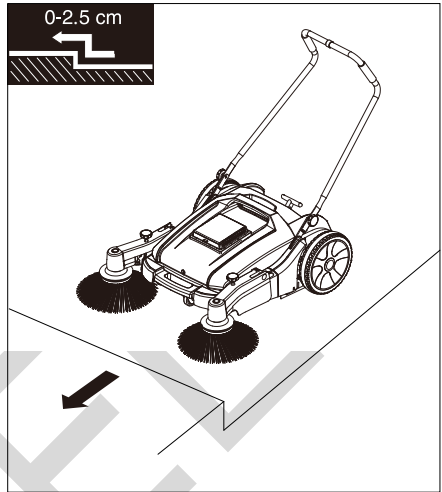

The cleaning surface should be competitive flat and height difference  $\leq 2.5$ cm.

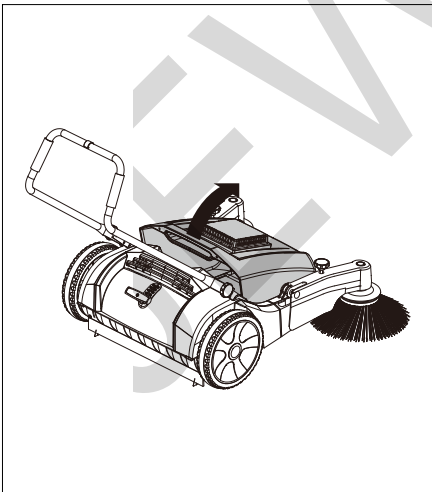

Lift the debris container handle and detach that.

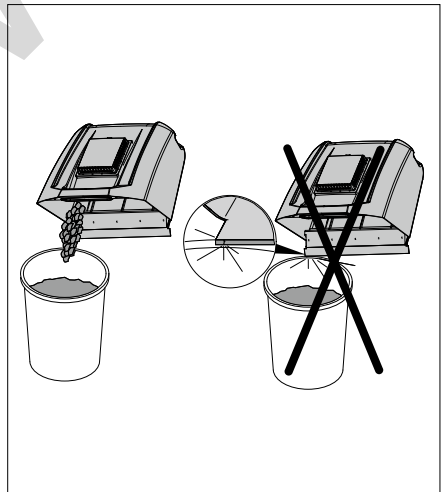

Pour the debris along one side. Crashing container is forbidden.

# HOW TO USE

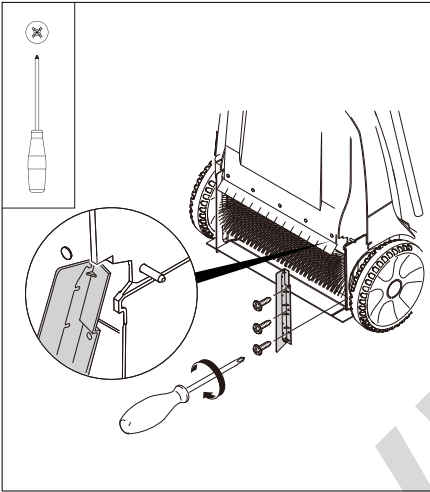

Set up the dustproof plates of both sides of main brush.

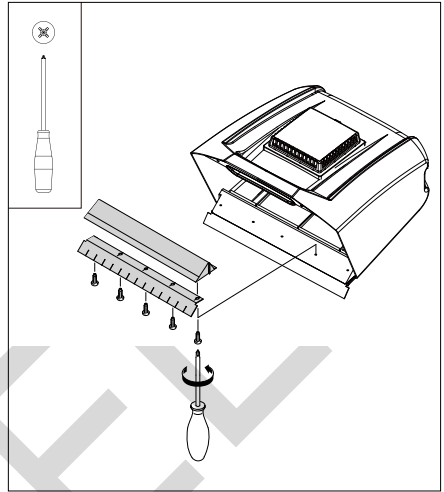

Install container seal baffle.

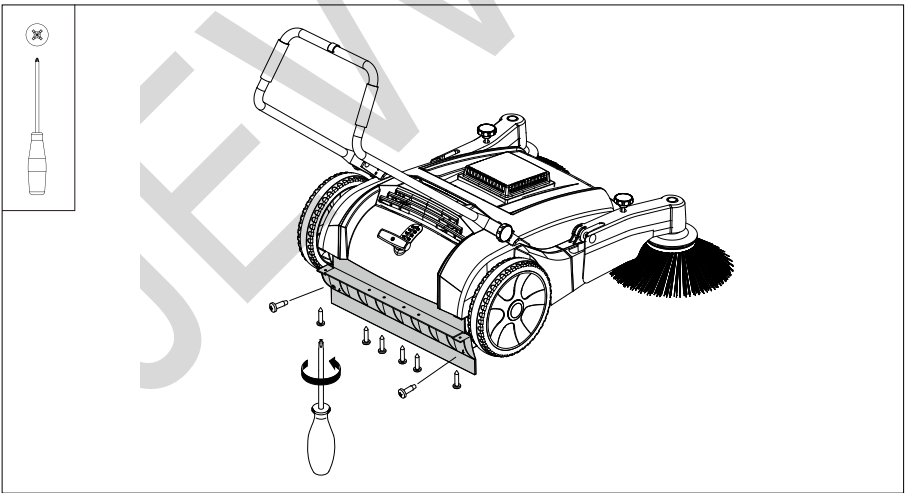

Install the dustproof plate on the back of main brush.

# HOW TO USE

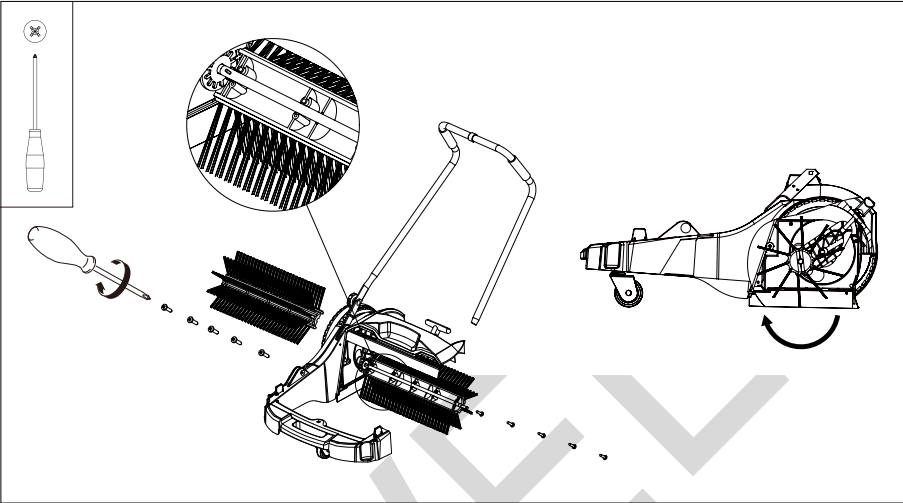

## Main brush replacement:

To dismantle the main brush, unscrew all 6 retaining screws.  
The two main brush half-shells can then be taken out.

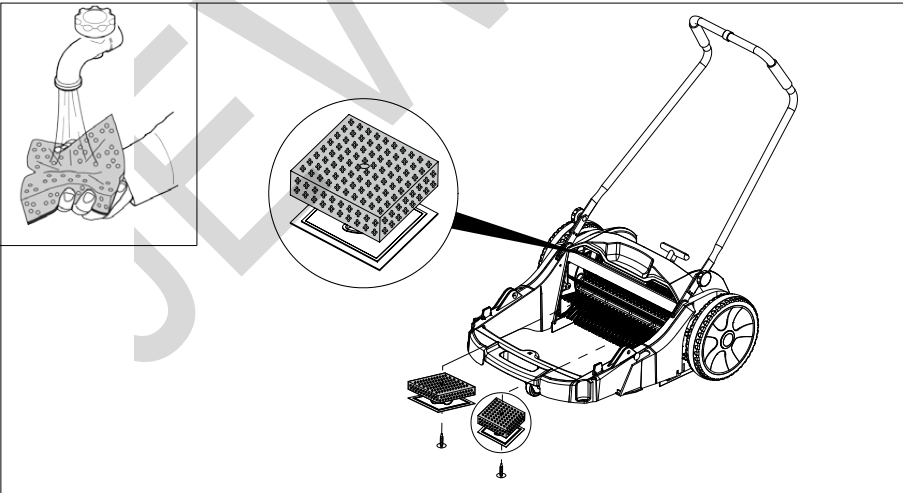

## Fine filter clean and replacement:

Pull out the retaining pin and remove the fine filter for cleaning or replacement.



## HOW TO USE

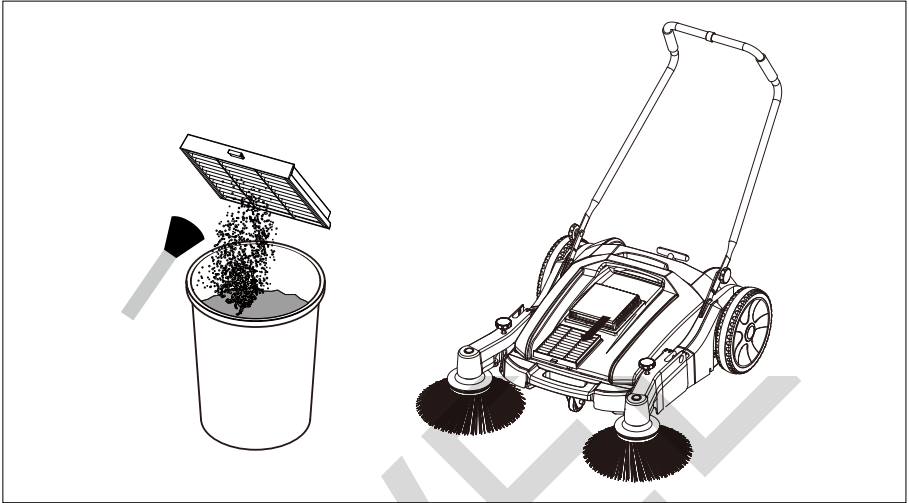

Cleaning the top filter by brush every month.

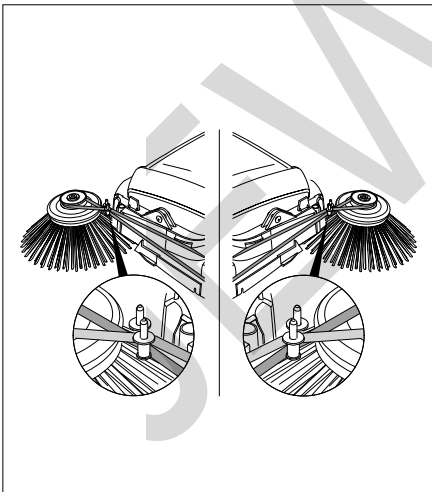

When installing the drive belt pay attention to the rotational direction of the side brush.

When moving forward, the side brush must rotate towards the inside.

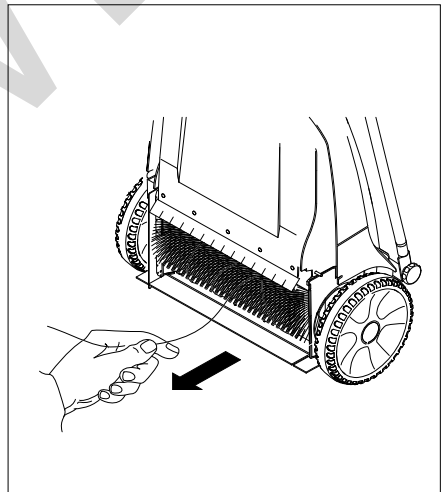

When the main brush is entangled in garbage, it should be taken out by reversing the roller brush.

SEVEN