

FER Series Instruction Manual

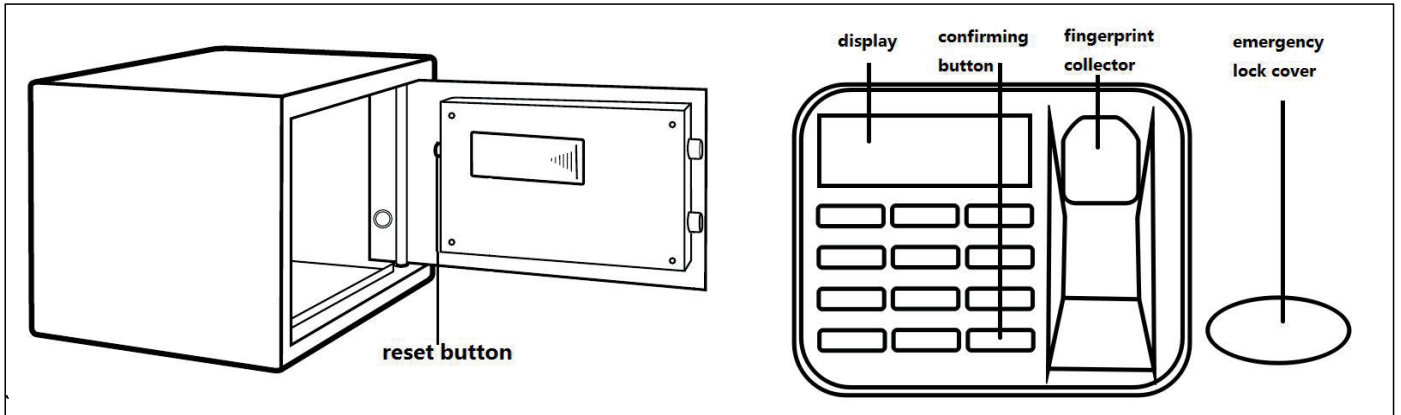

➤ Dear valued customer:

Thank you for choosing our products! You have taken an important step in organizing and protecting your most valued possessions. Every series of our safes is professionally made and designed to provide safety. Please take time to read and familiarize yourself with the proper operating procedures of your new safe presented on the following pages.

➤ Initial Use

- ① Find the emergency keys in the accessories' bag;
- ② Remove the emergency lock cover;
- ③ Insert the emergency key, press gently and turn it anticlockwise, clockwise turn the master key at the same time to open the door;

CAUTION: Finish operation, pull out the emergency key and keep it in a safe place.

➤ Insert the batteries

- ① With the door open, insert 4×1.5V batteries into the battery box;

CAUTION: Replace 4 fresh batteries by lining them up in a manner as indicated by the “+” and “-” signs.

➤ Open the door

Method one:

- ① Press “#” to wake up the collector;
- ② Put your finger at finger collector screen and hold on until the light goes out;
- ③ Then pull out the panel to open the door;

Method two:

- ① Input user code and press “*” to confirm;
- ② Then pull out the panel to open the door;

CAUTION: The preset user code is “1234”.

➤ Close the door

Press “#” or “*” to close the door.

➤ Lockout

① Three continuously wrong entries will activate the warning beep for 20 seconds and the panel will be locked for 3 minutes;

CAUTION: You can only stop the beeps by opening the safe with emergency key and power-cut by removing the battery.

➤ Set user code

- ① With the door unlocked, input user code;
- ② Press “*” and hold on until the LCD shows “-----” with one long Beep, then loose it;
- ③ After two short beeps, input new user code(4-6 digits) and press “*”;
- ④ After two short beeps, input new set user code again and press “*”;
- ⑤ The new code will be confirmed with a long “Bleep” and the panel display “OK”;
- ⑥ Three times short “Bleep” means registration is invalid;

➤ Fingerprint collect(20 fingerprints)

- ① With the door unlocked, press reset button;
- ② Put your finger at finger collector screen where the red light is on;
- ③ It will be confirmed with a long “Bleep” and show the no. of the code with “id ---”;
- ④ Three times short “Bleep” means registration is invalid;

➤ Factory reset

- ① Press reset button and hold on until the panel display “-----”;
- ② The code will be reset to “1234” and all the fingerprint information will be cleared up.

➤ Mounting

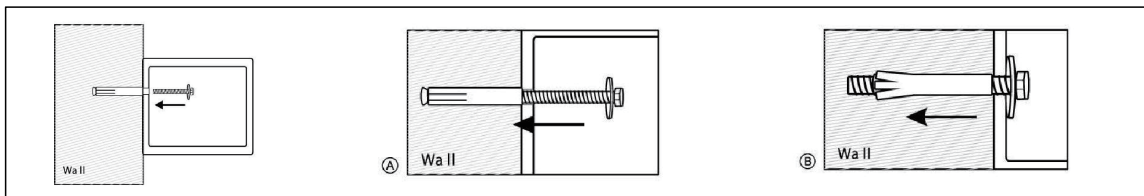

- ① Drill holes for expansion bolts(or clamping screws) in the right place;
- ② Use the expansion bolts(or clamping screws) to secure the safe to the wall or on the floor;
- ③ Make sure the safe is mounted in place as required and then tighten all bolts(screws).

CAUTION: Use the expansion bolt when there is a concrete wall surface.
Use the clamping screw when there is a wooden wall surface.