

Warning

- When you feel any abnormality, please turn off immediately the power .
- In using this product, please be conscious of the safety of the surroundings.
- Do not ride on the carrier.
- Do not attempt to discompose the wheels and controllers .
 - * May cause electric shock, fire or malfunction.
- Do not leave this product in the rain for a long time.
 - * May cause electric shock or malfunction.
- The battery is only for this product. Please consult with your dealer when replacing it with a new one.
- The AC/DC charger is for this product only . Do not use the charger expect for this product. When using the charger, please fully insert the plug into an AC outlet.
- Do not discompose the battery nor put it into a fire or heat it.
- When the fluid leaking from the battery by any chance adheres to your body, Should the fluid come into contact with your eyes, please rinse with clean water and go to a doctor for further treatment.
- In the case of disposing the battery, please follow local regulation.

Caution

- Despite noted in Caution, serious consequence may nevertheless occur depends on the situation under which the machine is used. Please read carefully this manual and use this product correctly in accordance with the instructions written herein.
- When not using the electric power drive, please turn off the switch .
 - * May extend the operating time of the battery.
- This product is an electric apparatus. Although certain waterproof measure is processed, please do not use this product in the water.
- The battery discharges by itself. Please charge the battery once every three month even when the unite is not in use.
- When an abnormality, such as smoking and smelling, is found by any chance, please turn off the power immediately.
- Please dispose this product in accordance with local ordinances.
- In the case of disposing the battery, please follow local regulation.

SPECIFICATIONS

Capacity	880 lb
Power rating	350 W
Battery type	Encapsulated lead-acid
Battery voltage rating	24
Charge time	8 h
Number of speeds	2
Speed rating (high-speed)	Forward 0 to 5.0 km/h Backward 0 to 3.0 km/h
Speed rating (low-speed)	Forward 0 to 3.5 km/h Backward 0 to 2.0 km/h
Tray size	43 in. (L) x 35 in. (W) x 19 in. (H)
Tray material	Polyethylene
Includes	Battery and rapid charger

HAZARD DEFINITIONS

Please familiarize yourself with the hazard notices found in this manual. A notice is an alert that there is a possibility of property damage, injury or death if certain instructions are not followed.

- DANGER!** This notice indicates an immediate and specific hazard that **will** result in **severe personal injury or death** if the proper precautions are not taken.
- WARNING!** This notice indicates a specific hazard or unsafe practice that **could** result in **severe personal injury or death** if the proper precautions are not taken.
- CAUTION!** This notice indicates a potentially hazardous situation that may result in minor or moderate injury if proper practices are not taken.
- NOTICE!** This notice indicates that a specific hazard or unsafe practice will result in equipment or property damage, but not personal injury.

INTRODUCTION

Featuring a 350 W wheel motor with overload protection, disc braking system, four pneumatic tires and battery indicator, this versatile tool is perfect for any situation. The switchable high/low forward and reverse speeds makes it easy to travel over most terrains while carrying loads up to 880 lb. This wheelbarrow can be used indoors or outdoors for many applications including hauling dirt, sod, sand, gravel, shrubs, wood, rocks and much more.

SAFETY

WARNING! Read and understand all instructions before using this tool. The operator must follow basic precautions to reduce the risk of personal injury and/or damage to the equipment.

Keep this manual for safety warnings, precautions, operating or inspection and maintenance instructions.

WORK AREA

1. Operate in a safe work environment. Keep your work area clean, well-lit and free of distractions. Place lights so you are not working in a shadow.
2. Keep anyone not wearing the appropriate safety equipment away from the work area.
3. Store unused tools properly in a safe and dry location to prevent rust or damage. Lock tools away and keep out of the reach of children.

PERSONAL SAFETY

WARNING! Wear personal protective equipment approved by the Canadian Standards Association (CSA) or American National Standards Institute (ANSI).

PERSONAL PROTECTIVE EQUIPMENT

1. Always wear impact safety goggles that provide front and side protection for the eyes. Eye protection equipment should comply with CSA Z94.3-07 or ANSI Z87.1 standards based on the type of work performed.
2. Wear gloves that provide protection based on the work materials or to reduce the effects of tool vibration.
3. Wear protective clothing designed for the work environment and tool.

4. Non-skid footwear is recommended to maintain footing and balance in the work environment.
5. Wear steel toe footwear or steel toe caps to prevent a foot injury from shifting loads.

PERSONAL PRECAUTIONS

Control the tool, personal movement and the work environment to avoid personal injury or damage to tool.

1. Do not operate any tool when tired or under the influence of drugs, alcohol or medications.
2. Avoid wearing clothes or jewelry that can become entangled with the moving parts of a tool. Keep long hair covered or bound.
3. Do not overreach when operating a tool. Proper footing and balance enables better control in unexpected situations.
4. Securely hold this tool using both hands. Using a tool with only one hand can result in loss of control.

SPECIFIC SAFETY PRECAUTIONS

WARNING! DO NOT let comfort or familiarity with product (gained from repeated use) replace strict adherence to the tool safety rules. If you use this tool unsafely or incorrectly, you can suffer serious personal injury.

1. Use the correct tool for the job. This tool was designed for a specific function. Do not modify or alter this tool or use it for an unintended purpose.
2. Do not use the tool if any parts are damage broken or misplaced. Repair or replace the parts.
3. Be aware of the surroundings while operating the tool.
4. If the machine is operating abnormally, immediately turn off the power and examine the tool before future use.
5. Do not ride in the bucket.
6. Do not attempt to discompose the wheels and controllers.
7. Do not leave the tool in the rain for an extended period of time or expose to water.
8. The battery is exclusively for this tool. Please consult with your dealer when in need of a replacement battery.

9. The AC/DC charger is exclusively for this tool. Do not use the charger for any other tool.
10. When charging the battery, please fully insert the plug into an AC outlet.
11. Do not discompose the battery nor expose it to fire or heat.
12. If fluid from the battery is leaking and breaches your skin, please rinse with clean water and contact a doctor for further treatment.
13. Turn off electric power switch when not in use.
14. Charge the battery every three months when the tool is inactive to avoid battery fluid leakage.

UNPACKING

WARNING! Do not operate the tool if any part is missing. Replace the missing part before operating. Failure to do so could result in a malfunction and personal injury.

Remove the parts and accessories from the packaging and inspect for damage. Make sure that all items in the parts list are included.

ASSEMBLY & INSTALLATION

Numbered references in parenthesis (#1) refer to the included Parts List. Dashed numbers in parenthesis (Fig. 1-1) refer to a specific point in an illustration or image.

1. Ensure all parts in the parts list are present.
2. Connect the power harness (25) to the handle frame (5) and secure with a screw.
3. Attach the handle frame (5) to the main frame (20) and secure using bolts.
4. Adjust the height of the handle frame (5) to a desired height.

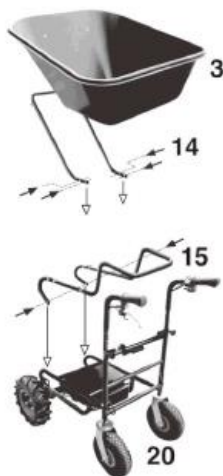

Fig. 1

5. Attach a drive shift lever to the drive shift device of the main body with an attached screw.
6. Attach bucket frame (15) to the bucket holder (14) with a fixed bolt (Fig. 1).
7. Connect the main frame (20) to the bucket frame (15) with an axis unit (Fig. 1).
8. Attach the bucket (3) to the bucket frame (15) and bucket holder (14) with a fixed bolt (Fig. 2).



Fig. 2

ADJUSTMENT

1. Check the pressure in both front and rear wheels regularly. Max. pressure for both is 30PSI.
2. To adjust the brakes, coordinate the length of the wire with the brake caliper (21), and fix the fine adjustment screw attached to the brake lever (8) to a desired tightness.
3. To adjust the handle height, select the desired height from one of the following options 31 in., 33 in., and 35 in. by lining up the labelled grooves with the fixed handle bolt (17).
4. Handles can turn by loosening the fixed handle bolt (17).



Fig. 3

OPERATION

NOTICE! Do not change drive/rear switch while driving the electric wheelbarrow.

1. Turn power switch (13) until the battery indicator (11) switches on.
2. Identify drive/rear switch (10) and set to desired position while the machine is fully stopped.

3. Identify the high/low speed switch (28) and set to desired position when machine is fully stopped.
4. Pull the brake lever (8) and release the brake lever stopper (9).
5. Switch on the speed controller (12) and the machine will begin moving.
6. Use the brake lever (8) to stop the machine when necessary.
7. When finished using the machine, ensure the brake lever (8) is activated using the brake level stopper (9).
Turn off the power switch (13).

BUCKET OPERATION

1. Ensure the bucket (3) is secure by activating the bucket lock (4) during loading and transportation (Fig 4).
2. When unloading, ensure the brake level stopper (9) is activated and then unlock the bucket lock (4) to knock down the bucket (3) (Fig. 5).



Fig. 4



Fig. 5

BATTERY OPERATION

NOTICE! Ensure the battery is fully charged using the included battery charger.

NOTICE! The battery discharges electricity naturally. Charge battery once every two months to avoid reduced battery performance.

1. Plug the battery charger power cord into a power supply.
2. Ensure the power cord is attached to the battery insert. A red light will shine on the charge lamp when the battery is charging.
3. The battery (18) is fully charged once the light turns green.

CARE & MAINTENANCE

1. Maintain the tool with care. A tool in good condition is efficient, easier to control and will have fewer problems.
2. Inspect the tool components periodically. Repair or replace damaged or worn components. Only use identical replacement parts when servicing.

3. Only use accessories intended for use with this tool.
4. Maintain the tool's labels and name plates. These carry important information. If unreadable or missing, contact Princess Auto Ltd. for replacements.

WARNING! Only qualified service personnel should repair the tool. An improperly repaired tool may present a hazard to the user and/or others.

DISPOSAL

Recycle a tool damaged beyond repair at the appropriate facility.

Contact your local municipality for a list of disposal facilities or by-laws for electronic devices, batteries, oil or other toxic liquids.

IMPORTANT! DO NOT pollute the environment by allowing uncontrolled discharge of waste oil.

TROUBLESHOOTING

Visit a Princess Auto Ltd. location for a solution if the tool does not function properly or parts are missing. If unable to do so, have a qualified technician service the tool.

PARTS BREAKDOWN

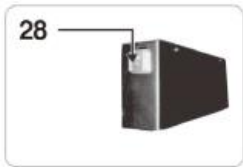
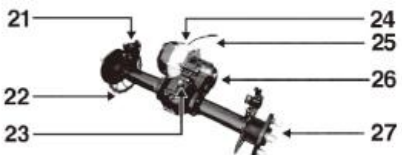

PARTS LIST

#	DESCRIPTION
1	Left handle
2	Right handle
3	Bucket
4	Bucket lock
5	Handle frame
6	Front wheel
7	Rear wheel (caster)
8	Brake lever
9	Brake lock
10	Drive/rear switch
11	Battery indicator
12	Speed controller
13	Power switch
14	Bucket holder
15	Bucket frame
16	Charge connector
17	Fixed handle bolt
18	Battery
19	Controller box
20	Main frame
21	Brake caliper
22	Brake disc
23	Differential gear
24	Motor
25	Power harness
26	Reducing gear
27	Wheel bolt
28	High/low speed switch