

Product Name And Model

Electric Impact Wrench
CT05102M005

Specifications

Operating Voltage	DC 12V
Max.Current	13A
Fuse	15A
Rated power	80W
Max.Torque	420N.M



ELECTRIC IMPACT WRENCH INSTRUCTION MANUAL



Please study the manual carefully before use operation.

"Except to the extent of the manufacturer's express representations and warranties stated herein, the manufacturer expressly disclaims and negates, and buyer hereby waives, any liability or responsibility of manufacturer or its affiliates for all representations and warranties, express, implied or statutory, including any warranty or representation, express, implied or statutory, as to the quality, merchantability or fitness for a particular purpose, or condition of this product or any part thereof."

Operation

1. Turn on the power of the car.
2. Plug into cigarette lighter or connect with the car's battery.
3. Choose the proper socket to the wrench's shaft. (FIG.1)
4. According to thread direction, press switch for tightening or loosening. (Do the reverse for L.H. screw) (FIG.2)
5. Press left side of the switch (with mark II) to start operation, and each nut will be loosened after two or three times of "clatter" sound.
NB: If the wrench pins with out impacting. Please start engine for maximum voltage.
6. Press right side of switch (with mark) to tighten nuts, it will be tight enough after two or three times of "clatter" sound.

OPERATION CHART

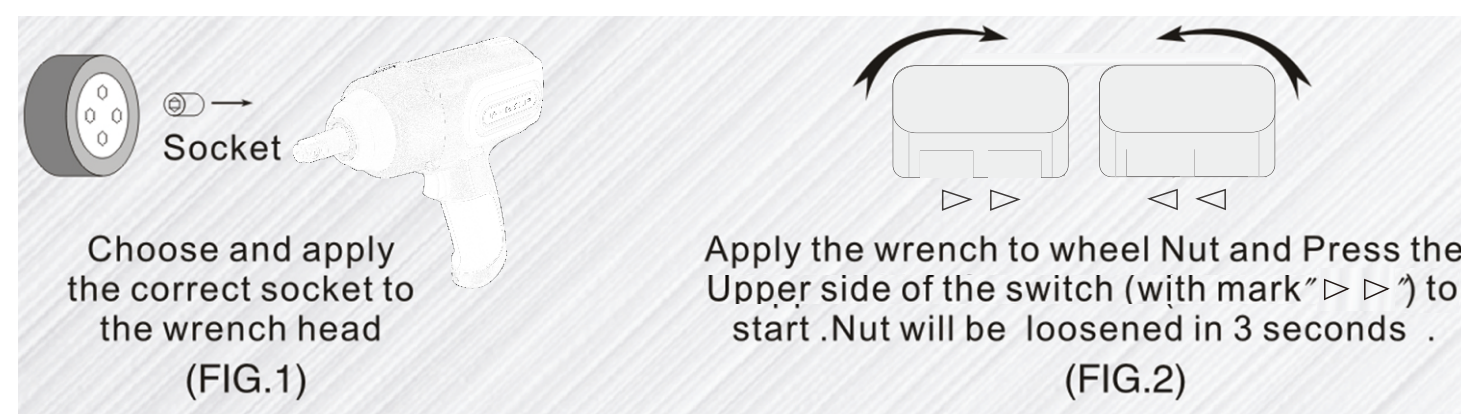

HOW TO REPLACE THE FUSE IN THE 12V PLUG

1. To replace the fuse in the plug, twist off the upper cover.
2. Remove the faulty fuse and insert a new one.
3. Twist the cover back on the plug. A spare fuse is enclosed in the case.



⚠ Caution

1. This tool can only be applied to DC12v Power.
2. Do not use the tool continuously more than 10 minutes.
3. Do not touch the shaft head with hand during operation.
4. When using the clips to car's battery, please make sure to connect clips to correct terminals of the battery. Red to positive and black to negative.
5. Do not use sockets not included in this kit.
6. New fuse's rated current should be or less than 12A.
7. Turn off the switch 3-5 seconds after the "clatter" sound is heard, the continue the operation.
8. The manufacturer recommends checking the tightness of the wheel nuts with a wheel brace after tightening with the impact wrench. The impact wrench is only for emergency use. Use a professional torque wrench to recheck the correct torque as soon as possible.
9. The manufacturer takes no responsibility for incorrect usage of this product and the impact wrench are only designed to loosen and tighten car wheel nuts'.

Troubleshooting

DANGER - Risk of fatal electric shocks.

Only have repairs to the tool or the power cord carried out by a professional experience technician.

1. Impact wrench will not start.

- Is the car battery dead?
- Is the cigarette lighter faulty?
- Is the fuse in the impact wrench faulty?

2. Wheel nut cannot be unscrewed or tightened.

- Has the correct rotational direction been selected?