

#### 4) Application Method

- (1) Stop the car. tension the car brake.
- (2) Check the switch whether it is to the close position, it should be to "O" state, if no. please do it so first, then connect the power plug into the car cigarette lighter.
- (3) Put the jack in the side of car tyre, and ensure the centre of Pressure Rod to align the loading part of automobile chassis, then rotate the adjusting screw to make it close to the automobile chassis as far as possible.
- (4) Adjust the direction switch to "△" then the jack will start to work, till the distance between the car tyre and the floor is about 5cm, reset the power switch while the power is disconnected, the machine would lock automatically and wouldn't fall.
- (5) After changing the tyre, adjust the direction switch to "▽", the jack would start to fall in constant speed.

#### 5) Specification

Input Voltage	DC 12V
Rated Power	180 W
Rated Current	15A
Fuse	15 A
Length of Power Cable	4 m
Max. Loading Car Weight	5.0T
Height Range	A:135-360mm B:155-450mm C: 155-450/235-530mm
Working Temperature	-15-50 °C
Jack size	320*130*130mm
Weight	4KS/4.28KS/5.08KS

#### 6). Fault Diagnosis

##### 1. Jack couldn't work

- a). Check whether turning on the auto power.
- b). The pilot lamp for the cigarette lighter plug is on or not, if not, please re-connect the plug; if re-connecting it, still no lighting, please check whether the inside fuse of the cigarette lighter plug is destroyed.
- c). Whether the plug for the power cable of jack is loosen with the jack or falling off.

**The socket is no electric or loosen, or check the cable, please connect the power correctly; Check the plug of cigarette lighter, whether the fuse is destroyed, if it is destroyed, pls replace it, then try again.**

## ELECTRIC HYDRAULIC JACK INSTRUCTION MANUAL



THANK YOU FOR PURCHASING OUR PRODUCTS AND PLEASE READ THIS MANUAL CAREFULLY BEFORE USING

#### Safety Warning:

- ?Please read this manual carefully before using.
- ?The material of the cover is plastic, which is easy to break, please handle it with care when using. Then if carrying it, please with the handle, NOT lifting the pressure rod.
- ?Do not overhaul the machine to avoid destroying the machine and lose the right of Guarantee.
- ?Do not work for long time, when not using, please cut off the power.
- ?Avoid the machine dropping into the water and using in the bad condition.
- ?Check the power to match well with 12V Car Cigarette Lighter before using.
- ?Take notice of the smooth floor and loading capacity when using, also pay attention to finding the exact loading position of the car before the operation of lifting.
- ?Do not overload when using the machine, make sure to keep upright with the lifting car at the same time, never operate it aslant.
- ?Do not pull the power cable casually when using,
- ?avoid the cable broken or short circuit.
- ?Make sure the car park in one side and close the engine before using.
- ?In the process of using the machine, ensure the operator stay with it all time, in case the operator have to leave for a short while, please shut off the machine first.
- ?The machine adopts the power of precise hydraulic oil. please keep the adequate ventilation, avoid doing it in the environment of high temperature and rather low temperature, while the suitable temperature should be from -15°C to 50°C.

#### 1)?Advantages

The machine is with the fashion and beautiful design, and adopts the advanced electric machinery technology. It is low noise, quick speeding, stable lifting performance and so on. Consi\*\*\*\*\* the safety, the machine designs self-locking \*\*\*\*\* structure and overloading protection device specially. That is to say: when the power has been disconnected, the lifted jack will not fall, only re-connecting the power, the jack will go on working, or using the safety valve to fall the car, which will protect the operator's personal safety effectively. Special design of super bright LED light, easy for night illumination. The machine is widely used for Family Car, Go-anywhere Vehicle, Multi-Purpose Vehicle.

#### 2)?Packing List

1. Portable Electric Jack One Piece
2. Instruction Manual One Piece
3. Accessories: two pieces of fuses for cigarette lighter, one of six-angle spanner

#### 3)?Introduction

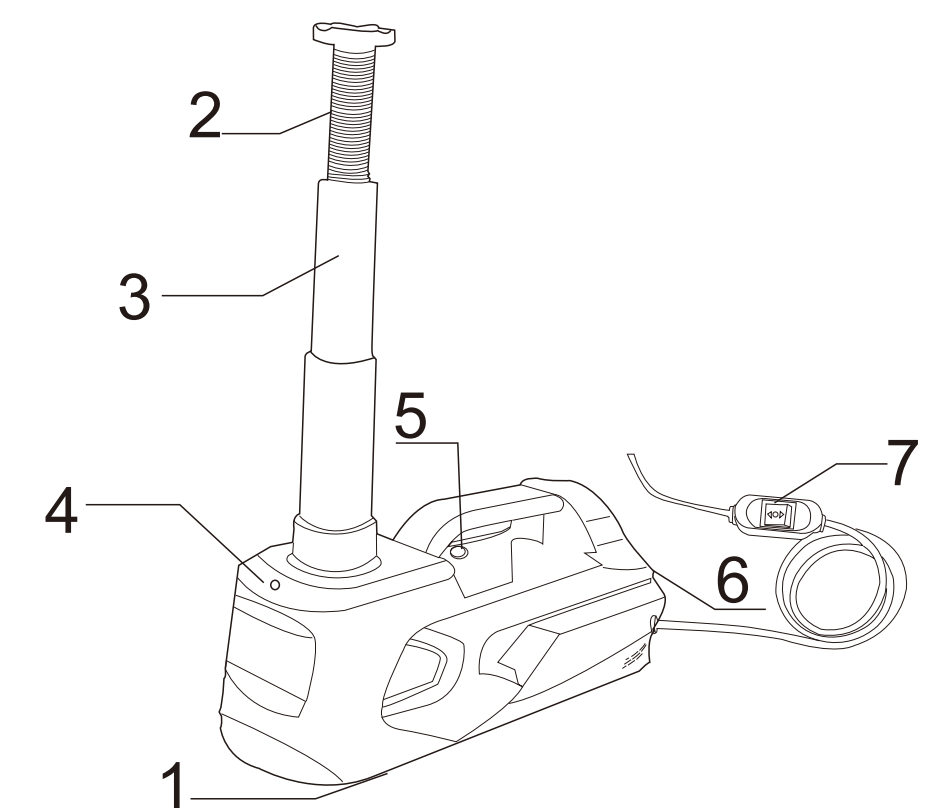

NO.	NAME	FUNCTION DESCRIPTION
1	The centre of Pressure Rod	Align the loading part of auto chassis
2	AdjustingScrew	Adjust the distance of the pressure rod and auto chassis
3	Pressure Rod	The rod is for lifting
4	LED Light	Easy for night illumination
5	Safety Valve	Unlock the pressure rod in emergency
6	The adapter of cigarette lighter	Connect the auto cigarette lighter
7	Direction Switch	Up/Close/Down△ /or/▽